

Engineering Data Sheet
Part No. SM204, 10.8V, 6.45Ah, 70Wh

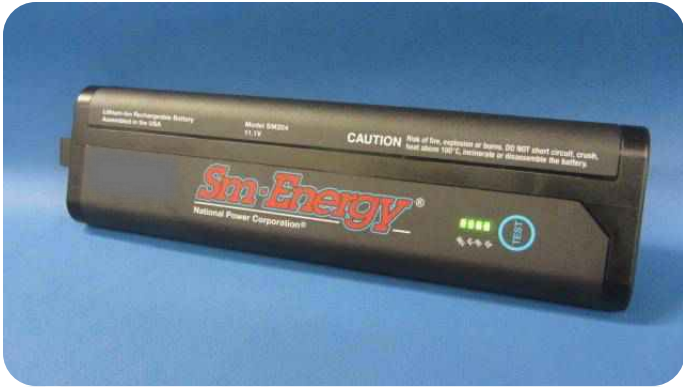

Dimensions

Millimeters Inches

	Maximum	Minimum	Maximum	Minimum
Contact Spacing	5.10	4.90	.201	.193
Contact to Key	9.10	8.90	.359	.351
Radius	11.20	10.69	.441	.421
Thickness	22.80	22.00	.897	.866
Width	59.10	58.47	2.327	2.302
Length	214.00	213.36	8.425	8.400

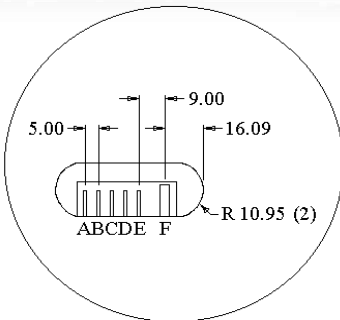

Terminals

- A - Negative
- B - I.D. Resistor
- C - Data
- D - Clock
- E - Positive
- F - Key

Chemical System: Lithium Ion (Li-Ion)
Battery Voltage: 10.8V
Typical weight: 472 grams approximate
Terminals: Recessed
Typical Capacity: 6450mAh
Smart Battery 1.1 Compliant

Capacity	Typical	6450 mAh
Effective Internal Resistance	Typical	150 milliohms
Maximum Discharge Current	Continuous	4.0A @ 25°C
Charging	Charging Voltage:	12.6V
	Charging Time: @ 4A	100% 2.5 hours
	Max Charging Current:	4.0A max
Temperature	Storage (°C)	-20°C to +50°C
	Discharge (°C)	-20°C to +60°C
	Charge (°C)	0°C to +40°C

Distributed by:

1573 Laperriere Ave. Ottawa ON K1Z 7T3
(613) 725-3704 www.cantecsystems.com

