

Engineering Data Sheet
Part No. SM206, 11.1V, 4.6Ah, 51Wh

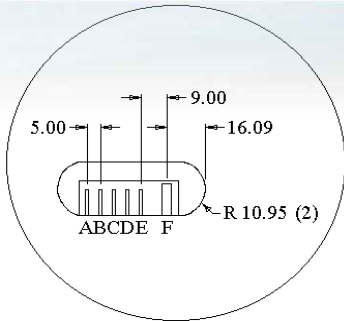

Terminals

- A - Negative
- B - Temperature
- C - Data
- D - Clock
- E - Positive
- F - Key

Chemical System: Lithium Ion (Li-Ion)
Battery Voltage: 11.1V
Typical weight: 326 grams approximate
Terminals: Recessed
Typical Capacity: 4600mAh
Smart Battery 1.1 Compliant

Dimensions

	Millimeters		Inches	
	Maximum	Minimum	Maximum	Minimum
Contact Spacing	5.10	4.90	.201	.193
Contact to Key	9.10	8.90	.359	.351
Radius	11.43	10.93	.565	.315
Thickness	22.90	21.80	.901	.858
Width	59.02	58.52	2.439	2.189
Length	150.74	150.24	6.049	5.799

Capacity	Typical	4600 mAh
Effective Internal Resistance	Typical	180 milliohms
Maximum Discharge Current	Continuous	3.8A @ 25°C
Charging	Charging Voltage:	12.6V
	Charging Time @ 2.4A:	100% 2.5 hours
	Max Charging Current:	2.4A
Temperature	Storage (°C)	-20°C to +50°C
	Discharge (°C)	-20°C to +60°C
	Charge (°C)	0°C to +40°C
UL Listed	File Number	MH27818

Distributed by:

1573 Laperriere Ave. Ottawa ON K1Z 7T3
(613) 725-3704 www.cantecsystems.com

