

Temperature compensation and user-initiated equalization cycle

Fast and accurate charging

Two or three-stage charging profiles

Power supply functionality

LED indicators and buzzer for operation and errors

Multiple stages of filtering for low EMI

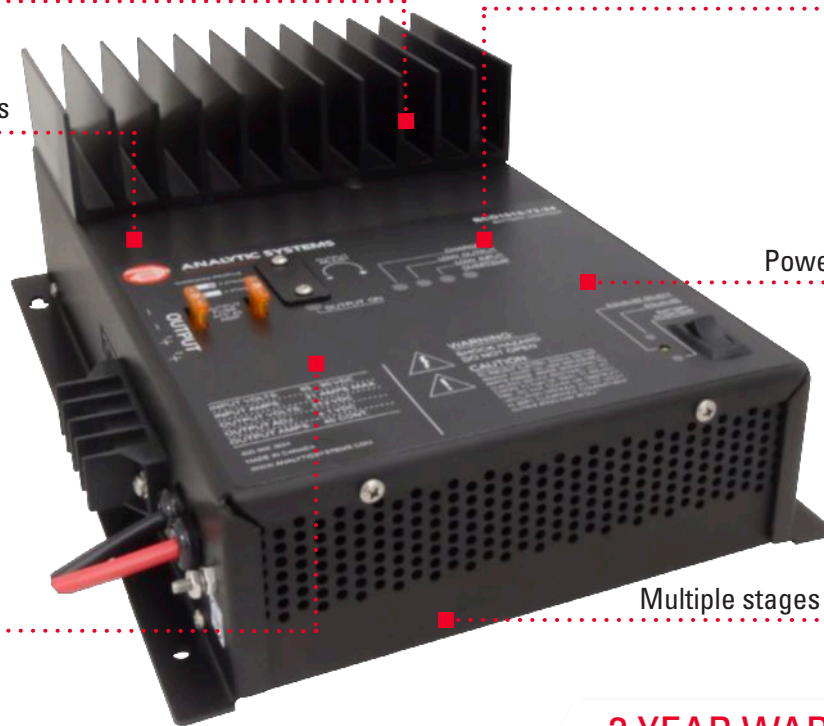

**3 YEAR WARRANTY**



**BCD1015 DC SOURCE BATTERY CHARGER**

The BCD1015 DC source battery charger provides up to 1000 watts of precision charging power to recharge up to two connected 12, 24, or 48 volt battery banks from a 24, 36, 48 or 72 VDC source. The batteries must share a common ground. In the absence of a battery, this unit can also function as a power supply up to its continuous current rating.

Internally, the proven current-mode switching design offers increased power and reliability while maintaining compactness of size. This unit features user-selectable two-stage or three-stage charging profiles, low ripple charging current, temperature compensation and a user-initiated equalization function to allow for gentle and controlled charging of expensive battery banks in order to prolong their lifespan.

Bright LED indicators and an audible alarm give the user an “at-a-glance” view of the charger’s operating condition. Safety features include an input fuse, thermal shutdown, current limiting, reverse battery hookup protection and output short circuit protection with automatic recovery.

**Available models**

Input

12 V	24 V	48 V
------	------	------

Output

24 V	36 V	48 V	72 V
------	------	------	------

**Applications**



# BCD1015 | DC SOURCE BATTERY CHARGER

## INPUT

Nominal Voltage	24 VDC	36 VDC	48 VDC	72 VDC
Actual Voltage	20-35 VDC	30-50 VDC	40-60V	65-90 VDC
Input Amps (Max)	66.7 A	45 A	33 A	21 A
Input Fuse (ATC)	40 x2	30 x2	20 x2	25 x1
Noise on Input	< 50 mV			

## OUTPUT

Nominal Voltage	12 VDC	24 VDC	48 VDC
Actual Voltage	14.4 VDC	28.8 VDC	57.6 VDC
Float Volts	13.6 ± 0.05 VDC	27.2 ± 0.05 VDC	54.4 ± 0.2 VDC
Charging Amps	60 A	40 A	20 A
Absorption to Float	9 Amps	6 Amps	3 Amps
Float Adjust	± 1.0 VDC		
Battery Banks	1 or 2		
Recommended Battery Capacity	240-360 Amp-Hours	160-240 Amp-Hours	80-120 Amp-Hours
Over Voltage Protection	16.0 ± 0.5 V	32.0 ± 1.0 V	63.9 ± 2.0 V
Temperature Compensation Coefficient	-30 mV /°C	-60 mV /°C	-120 mV /°C
Duty Cycle	Continuous for 24 Hours per Day		
Efficiency	> 80% @ Maximum Output		
Stages	2 or 3 (User-Selectable)		

## MECHANICAL

Dimensions	14.5 in / 36.8 cm Long x 9.9 in / 25.1 cm Wide x 5.0 in / 12.7 cm High
Clearance	1.0 in / 2.5 cm all around
Weight	12.0 lb / 8.2 kg
Material and Finish	Marine Grade Black Anodized Aluminum with
Fasteners	18-8 Stainless
Connections	Input - 10 AWG Type D Stranded Flying Leads (Black: Negative, Red: Positive) Output - Eaton Magnum A48430404 Four Position Terminal Block

## ENVIRONMENTAL AND SAFETY

Operating Temperature Range	-25°C to +40°C @ maximum output. Derate Linearly 2.5% per °C from 40°C (Optional -40°C extra wide temperature operation available)
Humidity	0 - 95% Relative Humidity (non-condensing) with standard conformal coating
Isolation	Input-Case, Input-Output and Output-Case: 1500 VDC
Audible Noise	34.5 dB when fans operating
Typical Service Life	> 10 years (87,600 hrs)
Warranty	Three years parts and labor
Safety	Designed to meet CSA 22.2.107.1 & UL458

Note: Specifications are subject to change without notice.

## OPTIONS

European ROHS Compliant  
(Lead Free Manufactured)

Battery Backup Functionality

Open Frame  
(No chassis, just heat sink bars)

Safety Special Inspection (CSA/UL)

Chassis-integrated Digital Voltmeter/  
Ammeter

Heavy-duty Ruggedization with  
Expanded Operating Temperature

Custom Input/Output Voltages  
Available

## DIMENSIONS

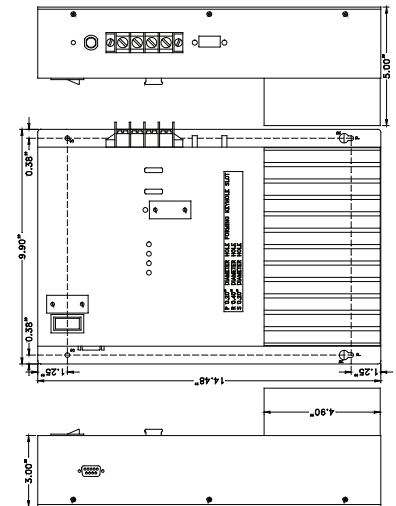

**ANALYTIC SYSTEMS**  
Power Conversion Solutions



AnalyticSystems.com



Sales@AnalyticSystems.com



604.946.9981 800.668.3884



8128 River Way  
Delta, B.C. V4G 1K5